

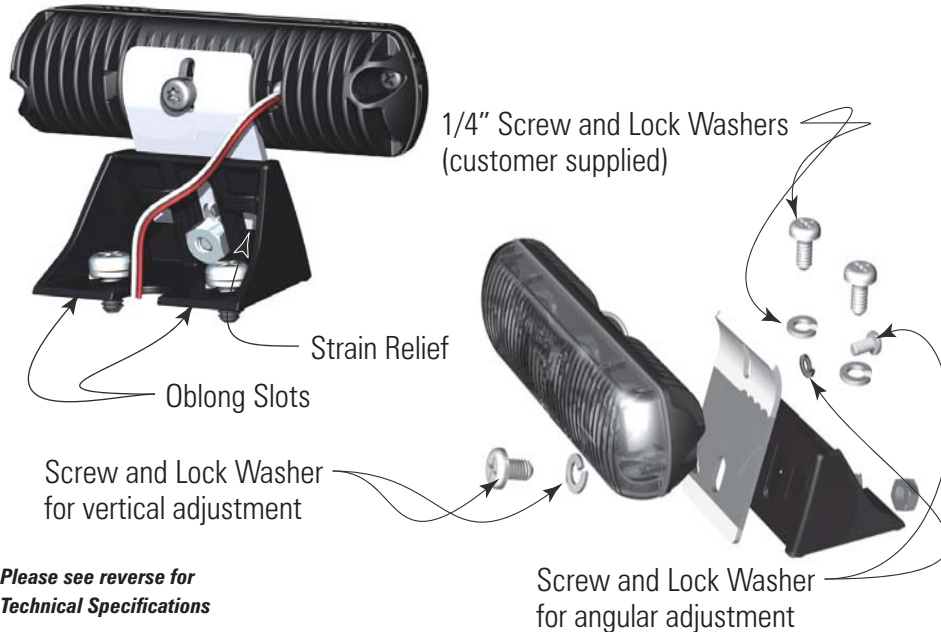

by SoundOff Signal

## XP 63 LED LIGHT 10-30V

EL6GD30(x)



Please see reverse for Technical Specifications

### Important Information:

- Warning devices are strictly regulated and governed by Federal, State and Municipal ordinances. These devices shall be used ONLY on approved vehicles. It is the sole responsibility of the user of these devices to ensure compliance.
- DO NOT install this product or route any wires in the Air Bag Deployment Zone. Refer to your vehicle Owner's Manual for the location of any air bag deployment zones.
- DO NOT connect this device to a strobe power supply. This product is self-contained and does not require an external power supply.

### BRACKET MOUNTING

**IMPORTANT:** DO NOT over tighten mounting screws or nuts. This could cause permanent damage to the bracket or case.

**NOTE:** The XP63 is shipped preassembled. Some disassembly is required to properly mount and align light.

1. Locate flat or slightly arched mounting location for XP63 Bracket.
2. When position of bracket is determined mark location of oblong slots assuring that light will be perpendicular to long axis of vehicle and drill pilot holes. If wires are to be routed to interior of vehicle a hole should be made between the pilot holes. If the connection is to be made inside the vehicle this can be a small hole but if the cable is to pass through the surface it must be large enough to accommodate the connector.
3. Place bracket over pre-drilled pilot holes and secure to vehicle using 2-1/4" customer supplied screws and lock washer (preferably stainless steel). DO NOT OVER TIGHTEN SCREWS.
4. Make cable connections as follows: Red-power, Black-ground. White is for ID and pattern selection and will be taped after selection is made. If the final location of the cable will be inaccessible, ID and pattern selection must be made before final installation. Loose wires from the light should be wrapped under the strain relief in the base.
5. Light is adjusted by loosening the vertical and angular adjustment screws and positioning the light for optimum performance. Make certain that light is positioned horizontally and at the desired height.

### OPERATING INSTRUCTIONS

The XP63 comes equipped with its own selectable 33 pattern flasher and pattern memory. When desired pattern is selected, it will automatically be stored in the unit's memory and will come up every time the light is turned on.

1. Connect the unit's BLACK wire to a good, convenient ground.
2. Connect the unit's RED wire to one side of a user supplied on/off switch. Connect the other side of the switch, through a 7.5Amp fuse, to a source of +10-30Vdc.

### PATTERN SELECTION

1. Turn unit ON.
2. Touching and removing the WHITE wire to ground will advance the XP63 to the next flash pattern. See flash pattern table. Continuing to touch and remove the WHITE wire to ground will allow you to scroll through the pattern list. After pattern #16 is reached the list will start over again at pattern #1.

**NOTE:** The unit is equipped with flash pattern memory. Once you have selected a pattern the unit will always activate to that pattern every time the unit is turned on. Tape up and secure WHITE wire so that it will not accidentally change your selected pattern.



To review our Limited Warranty Statement & Return Policy for this or any SoundOff Signal product please visit our website at [www.soundoffsignal.com](http://www.soundoffsignal.com) and select the "Warranty & Returns" link along the left column of our home page. If you have questions regarding this product please contact Technical Services, Monday - Friday, 8 am to 5 pm at 1.800.338.7337, press #4 to skip the automated message. Questions or comments that do not require immediate attention may be emailed to [techsupport@soundoffsignal.com](mailto:techsupport@soundoffsignal.com).

1.800.338.7337. / [www.soundoffsignal.com](http://www.soundoffsignal.com) / Thank you for trusting us with your safety!



by SoundOff Signal

## XP 63 LED LIGHT 10-30V

EL6GD30(x)

| WIRE HOOK-UP TABLE |                   |
|--------------------|-------------------|
| WIRE COLOR:        | CONNECT TO:       |
| RED                | + 10-30Vdc        |
| BLACK              | Ground (-)        |
| WHITE              | ID/Pattern Select |

| TECHNICAL SPECIFICATIONS |                                     |
|--------------------------|-------------------------------------|
| Overall Dimensions:      | 3.38"(2.88"min)"H x 5.13 W x 2.63"D |
| Flash Patterns:          | 33 flash patterns                   |
| Input Voltage Range:     | 10-30Vdc                            |
| Current Consumption:     | < 1 amp*                            |
| # of LEDs:               | 6 Generation 3 LEDs                 |
| Light Sync Technology:   | Yes                                 |
| Operating Temperature:   | -40° to +65° C                      |

\*Pattern Dependent

NOTE: The light CANNOT be serviced in the field. Any attempt to gain access to the unit will most likely cause permanent damage and void its warranty.



### Predator Sync Configuration Instructions

**IMPORTANT! A MAXIMUM OF 4 SINGLE LIGHTS CAN BE SYNCED TOGETHER**

- Set ID#
  - Identify which pattern and sequence you want and look up ID# settings at right.
  - Connections
    - RED: + 10-30Vdc
    - WHT: + 10-30Vdc (Note: you will need to disconnect after power is applied)
    - BLK: Ground
  - Apply power to unit
  - Without disconnecting power from unit, disconnect WHT wire
  - Momentarily connect WHT to Ground to change ID #
    - Identify ID# by number of sequential flashes
    - Possible ID#s: 1 – 4
  - Disconnect power from unit to get out of ID mode.
- Set Pattern
  - Reapply power to units.
  - Once all Light Head ID#s are configured, make sure all lights are flashing the same pattern
  - Connect corresponding colored wires of all units together: RED to RED, etc.
  - Change Pattern
    - Momentarily connect WHT wires to Ground
    - Observe pattern change on all lights connected
  - Insulate all wires by taping with electrical tape
- Connect Master Switch for Application
  - IMPORTANT!** Ensure WHT Pattern/Sync Wires are tied together

#### 1 LIGHT

Single Light Operation: Follow the ID Selection steps and set the LED3 to ID#1 if it is not already. NOTE: Steady Burn is produced for patterns 9 & 10 in Single Operation.

#### 2 LIGHTS

ALTERNATING: To obtain Alternating patterns, follow the ID SELECTION steps and set one LED3 to ID#1 and the other to ID#3. Then proceed to the PATTERN SELECTION steps.

SIMULTANEOUS: To obtain Simultaneous patterns, follow the ID SELECTION steps and set both LED3 lights to ID#1. Then proceed to PATTERN SELECTION steps.

#### 4 LIGHTS

X-Pattern: To obtain X-patterns, follow the ID SELECTION steps and set one of the four LED3 lights to ID#1, one to ID#2, one to ID#3, and one to ID#4. Then proceed to PATTERN SELECTION steps. NOTE: Be sure to mount each LED3 in the correct placement based on ID#.

X-Pattern Sequence  
ID#1 > ID#4 > ID#2 > ID#3

X-Pattern Light Head Placement

|      |      |
|------|------|
| ID#4 | ID#2 |
| ID#3 | ID#1 |

| Flash Patterns             |         |                      |                       |                    |                           |
|----------------------------|---------|----------------------|-----------------------|--------------------|---------------------------|
| Pattern Name               | 1 Light | Alternating 2 Lights | Simultaneous 2 Lights | X-Pattern 4 Lights | F.P.M. (Flashes / Minute) |
| 1. Quint                   | x       | x                    | x                     |                    | 70                        |
| 2. Warp                    | x       | x                    | x                     |                    | 350                       |
| 3. Inter-Cycle Flash       | x       | x                    |                       |                    |                           |
| 4. Double Flash            | x       | x                    | x                     |                    | 70                        |
| 5. Quad Flash              | x       | x                    | x                     |                    | 80                        |
| 6. PowerPulse™             | x       | x                    | x                     |                    | 180                       |
| 7. RoadRunner™             | x       | x                    | x                     |                    | 113                       |
| 8. Q-Switch™               | x       | x                    |                       |                    |                           |
| 9. RoadRunner™ Steady Burn | x       | x                    |                       |                    | 113                       |
| 10. Quad Steady Burn       | x       | x                    |                       |                    | 80                        |
| 11. E-Ideal Single Flash   | x       | x                    | x                     |                    | 200                       |
| 12. E-Ideal Double Flash   | x       | x                    | x                     |                    | 146                       |
| 13. Quad2 Flash            | x       | x                    | x                     |                    | 67                        |
| 14. Double2 Flash          | x       | x                    | x                     |                    | 95                        |
| 15. X-Warp                 |         |                      |                       | x                  |                           |
| 16. X-Double               |         |                      |                       | x                  |                           |
| 17. PowerRunner            | x       | x                    | x                     |                    |                           |
| 18. LCR Quint              | x       | x                    | x                     |                    |                           |
| 19. Warp <sup>3</sup>      | x       | x                    | x                     |                    |                           |
| 20. Ultra Warp             | x       | x                    | x                     |                    | 545                       |
| 21. Thunder & Lightning    | x       | x                    |                       |                    |                           |
| 22. Lite Speed             | x       | x                    | x                     |                    | 85                        |
| 23. SuperSonic             | x       |                      | x                     |                    | 170                       |
| 24. LCR Lite Speed         | x       | x                    | x                     |                    |                           |
| 25. SuperSonic Ultra       | x       | x                    | x                     |                    |                           |
| 26. Tempo Shift            | x       | x                    | x                     |                    |                           |
| 27. Tempo Shift Warp       | x       | x                    | x                     |                    |                           |
| 28. SBE2                   | x       | x                    | x                     |                    | 67                        |
| 29. C <sup>2</sup>         | x       | x                    | x                     |                    | 200                       |
| 30. U <sup>2</sup>         | x       | x                    | x                     |                    | 176                       |
| 31. Ultra Glow             | x       | x                    | x                     |                    |                           |
| 32. Cyclone                | x       | x                    | x                     |                    |                           |
| 33. Chameleon              | x       | x                    | x                     |                    |                           |